



Erika Franceschelli
Service Sales Manager,
Rigid Packaging BU

SACMI After Sales Service Session



Contents

Life Extension

Advanced Services

Predictive Maintenance Approach

SACMI S.P.A.C.E.

Contents

Life Extension

Advanced Services

Predictive Maintenance Approach

SACMI S.P.A.C.E.

Life extension | Innovative solutions for your existing machines

Any installed machines can be improved/updated with additional features and options to **improve performance and functionality.**

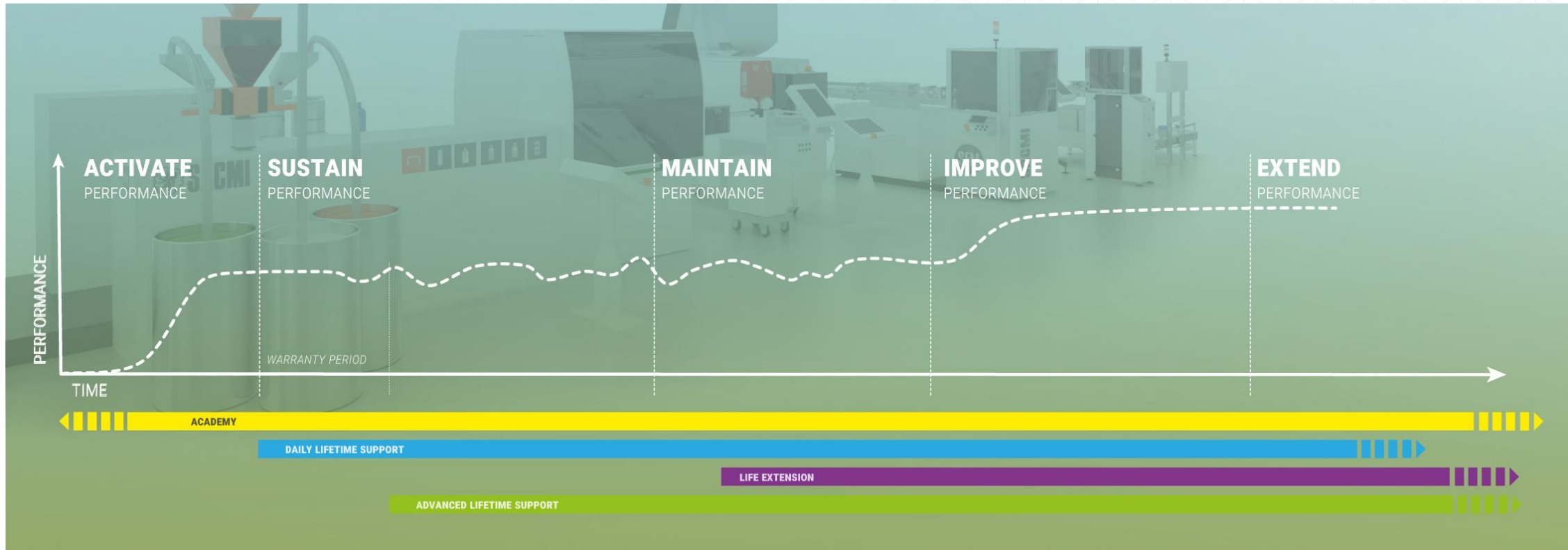

Life extension | Your advantages

COST SAVINGS



EFFICIENCY



EXTENDED
PERFORMANCE



QUALITY



SACMI kits leverage advanced and proven technical solutions to target key goals:

Improve the overall performance of the equipment

Increase equipment lifetime

CCM Forming drums with bushings Upgrade

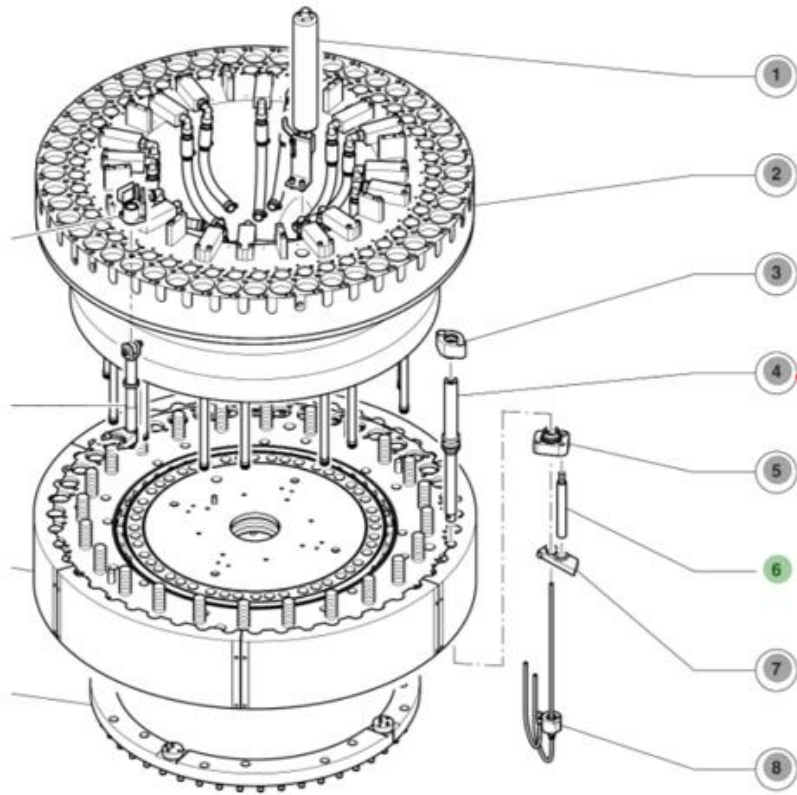

Available for all CCM machines this upgrade moves from standard drum to bushing drum introducing the following benefits:

- Reuse** and update the old forming drum
- Resolve wearing problem
- Easy replacement of a single bushing



Product Customizations like

- Cavity bottoms with logo replacements
- Knurls design modifications
- Standard 360° scoring patterns modification



CCM Smart Pack Upgrade



For CCM48SD generation is possible to install the new package of sensors (Smart PACK1) and unlock the advanced in-line controls

Activate the latest technologies to

Reduce time of debugging

Let “**Easy of use**” experience for line operators

Have **continuous** product and process quality control

Introduce **self-adjustment** of fast phenomena aimed at maintaining production **STABILITY**



Auditing service for technical energy performance analysis



Auditing service for technical energy performance analysis



Check-up points with data analysis on:

- plasticization process
- thermoregulation process
- hydraulic unit
- forming carousel



On **CCM48SD** these upgrade let you **SAVE** from 5 to 25%
of CCM total energy consumption

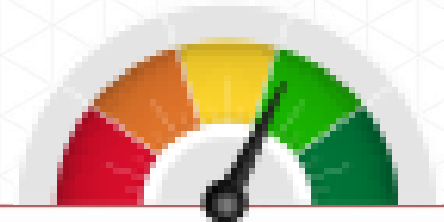

Contents

Life Extension

Advanced Services

Predictive Maintenance Approach

SACMI S.P.A.C.E.

Portfolio of After Sales Services



Smart & Secure maintenance contracts

tailored to the customer's needs

Service Network & Suggested spare part lists

consisting of local service and strategic parts to support both preventive maintenance tasks and any unscheduled stops

Technical training

by SACMI ACADEMY

Smart & Secure service | Preventive maintenance contracts &... more



Smart Service features...

- Planned technical services on site
- Machine/mould check-up
- Replacements of parts according to the maintenance plan
- Flexible visit scheduling according to Customer production plans
- Original Spare parts included for Preventive Maintenance
- Coaching

And Secure Service adds the following services

- Replacement of parts after unexpected events
- Unscheduled 'callout' technical services
- Activation of task established and guaranteed by the contract

Service Network | & Suggested spare part lists



- All local engineers are part of **SACMI's know-how sharing network**
- SACMI has multiple Technical Hubs consisting of specialized, dedicated teams of engineers who can **connect directly to provide Tele-assistance**
- **Only OEM spare parts and spare parts made to SACMI specifications can guarantee lasting original machine performance, with lower total cost of ownership**

Technical training | Customized training solutions



In person at SACMI HQ and at customer's facility with a senior professional team, also available for Remote sessions, with **tailored sessions** on:

- Technology and processes
- Basic and Advanced maintenance for mechanical & automation staff
- Troubleshooting
- Preventive maintenance
- Quality control

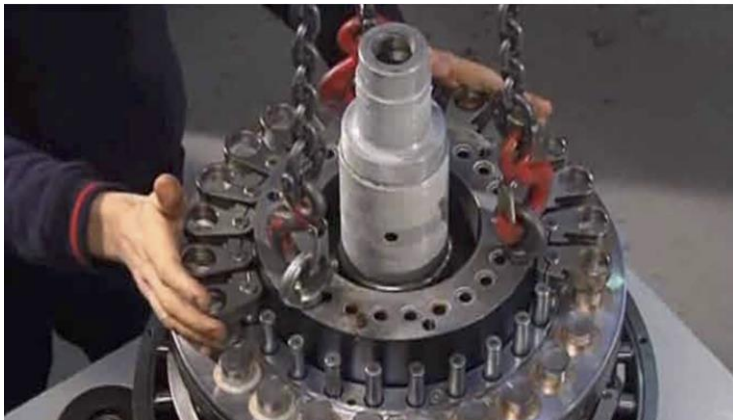

Contents

Life Extension

Advanced Services

Predictive Maintenance Approach

SACMI S.P.A.C.E.

Advanced service | Predictive maintenance approach

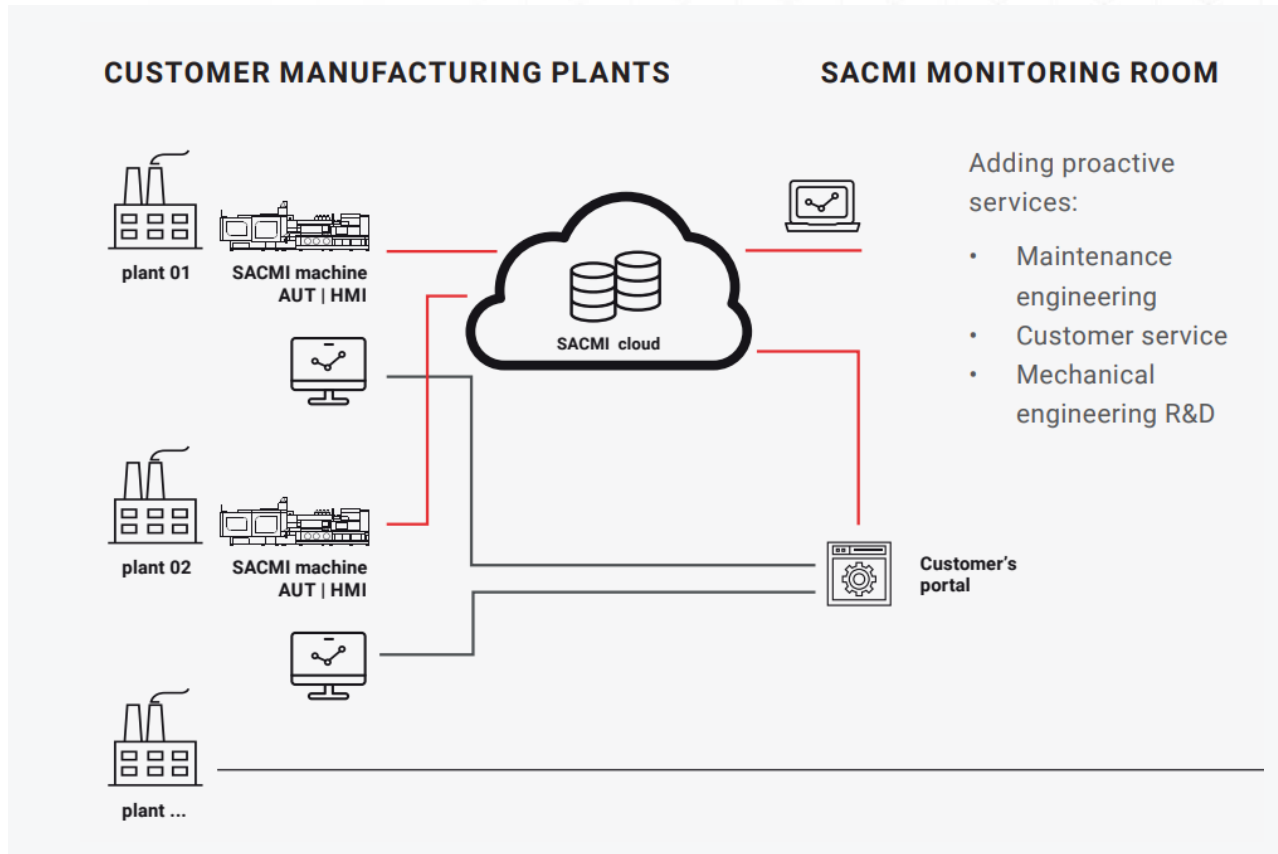

Smart care service

- KPI monitoring system, machine health status
- Prediction system for PREDICTIVE maintenance activities
- CLOUD Architecture
- The customer can access the platform, consult the dashboards, and take action independently

Provided an enhanced predictive maintenance strategy, available for the latest generation of machines

Advanced service | Predictive maintenance approach

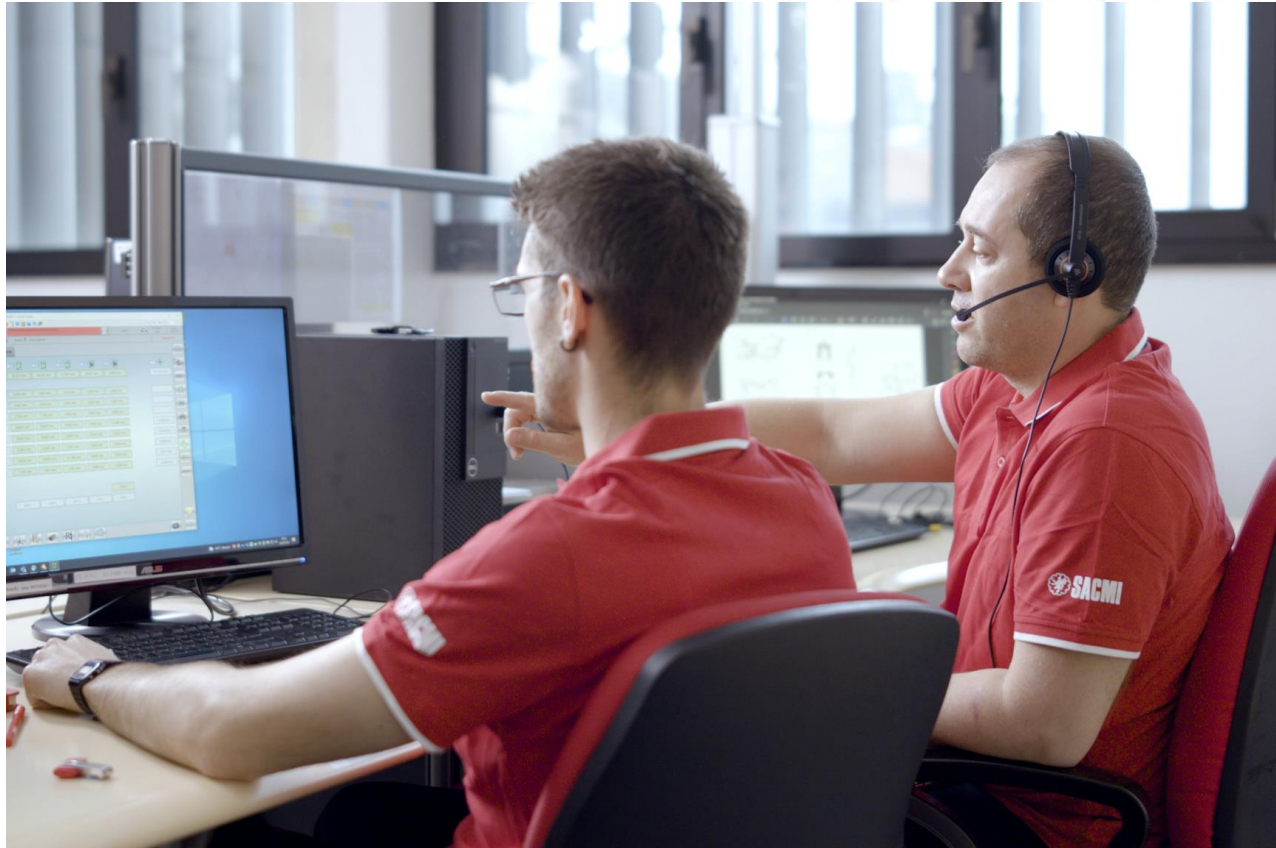

Different service levels

- PREMIUM for REMOTE engagement with the SACMI team
- PREMIUM plus MAINTENANCE contract to combine REMOTE monitoring from SACMI with periodical SACMI ON-SITE visits to perform maintenance tasks

Contents

Life Extension

Advanced Services

Predictive Maintenance Approach

SACMI S.P.A.C.E.

SACMI S.P.A.C.E. | SACMI Portal For Aftersales And Customer Service Excellence

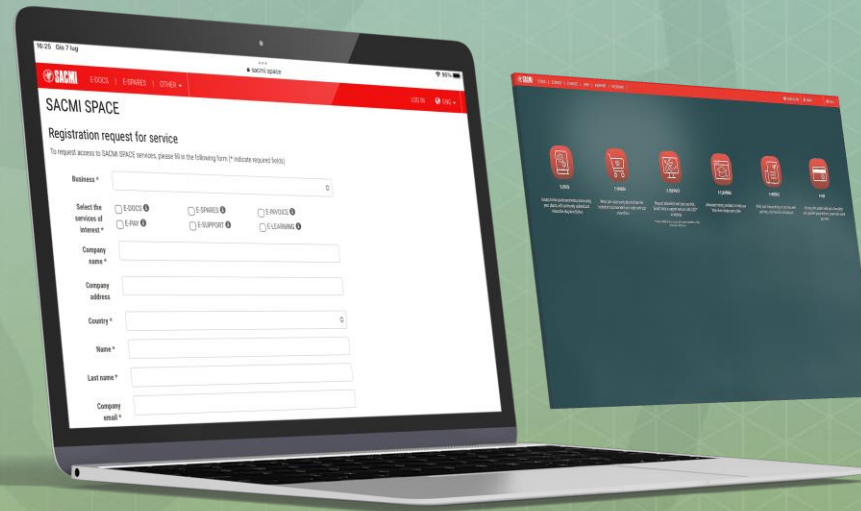
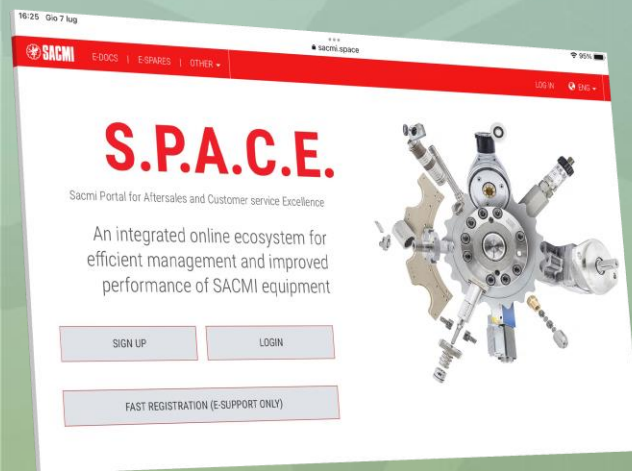

Easy registration on the platform

“Fast track” available

Customized “welcome page”



SACMI S.P.A.C.E. | E-docs

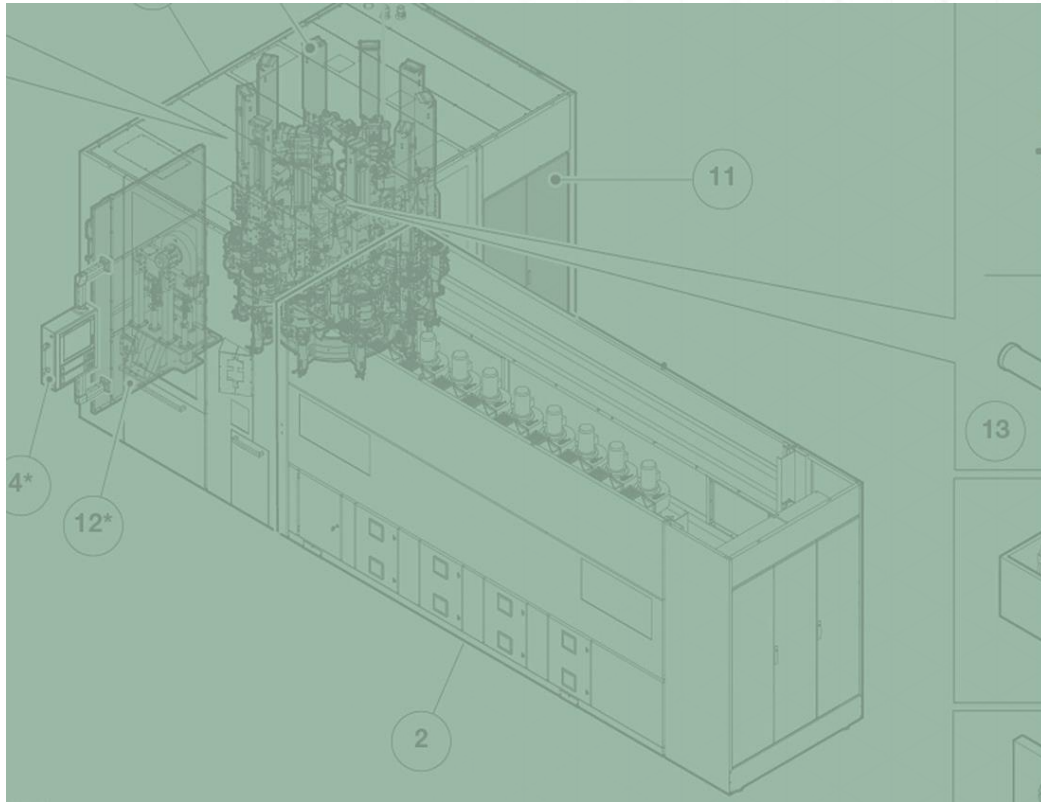

Digital access to comprehensive machine documentation

- use and maintenance manuals
- declarations of conformity
- spare parts catalogues
- mechanical/wiring diagrams
- and much more...

Documents constantly updated

- e.g. after upgrades of the machine



SACMI S.P.A.C.E. | E-spares

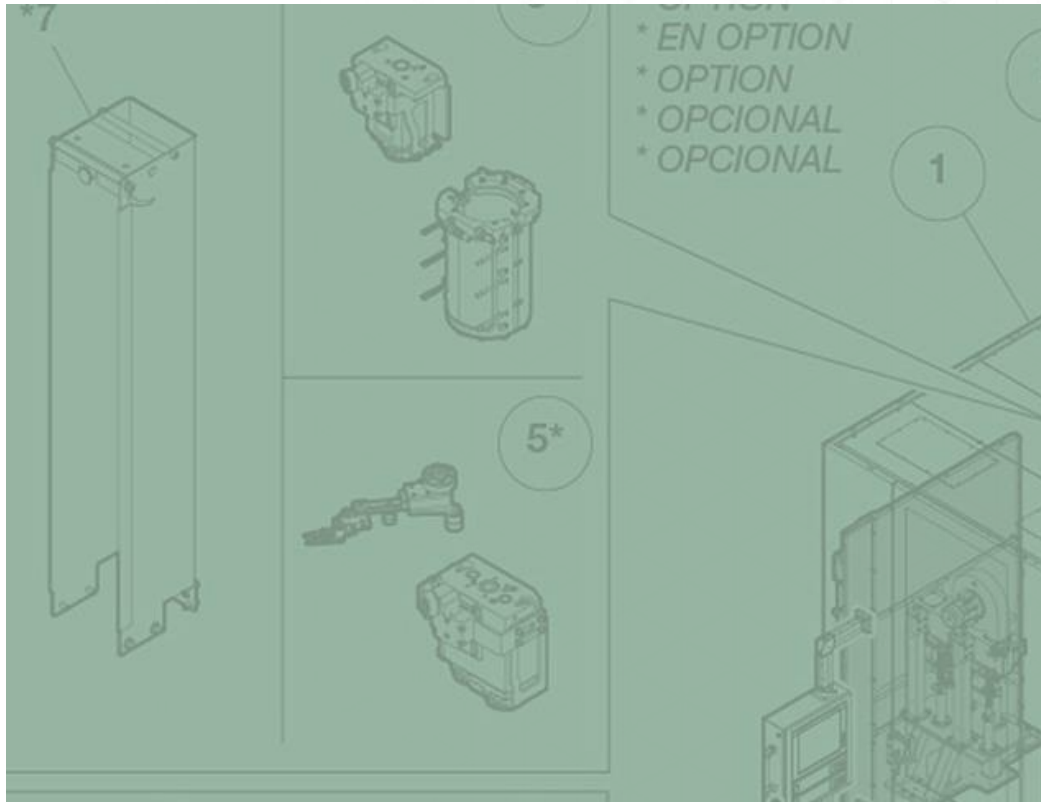

A fast and accurate spare parts service

Quicker identification of the right spare parts

Online accessible 3D catalogues

Request offers and order spare parts
DIRECTLY ON LINE

NEW

View and compare on line availability, price and delivery time of your spare parts*

* Only available in some areas. Verify coverage with SACMI



SACMI S.P.A.C.E. | E-learning

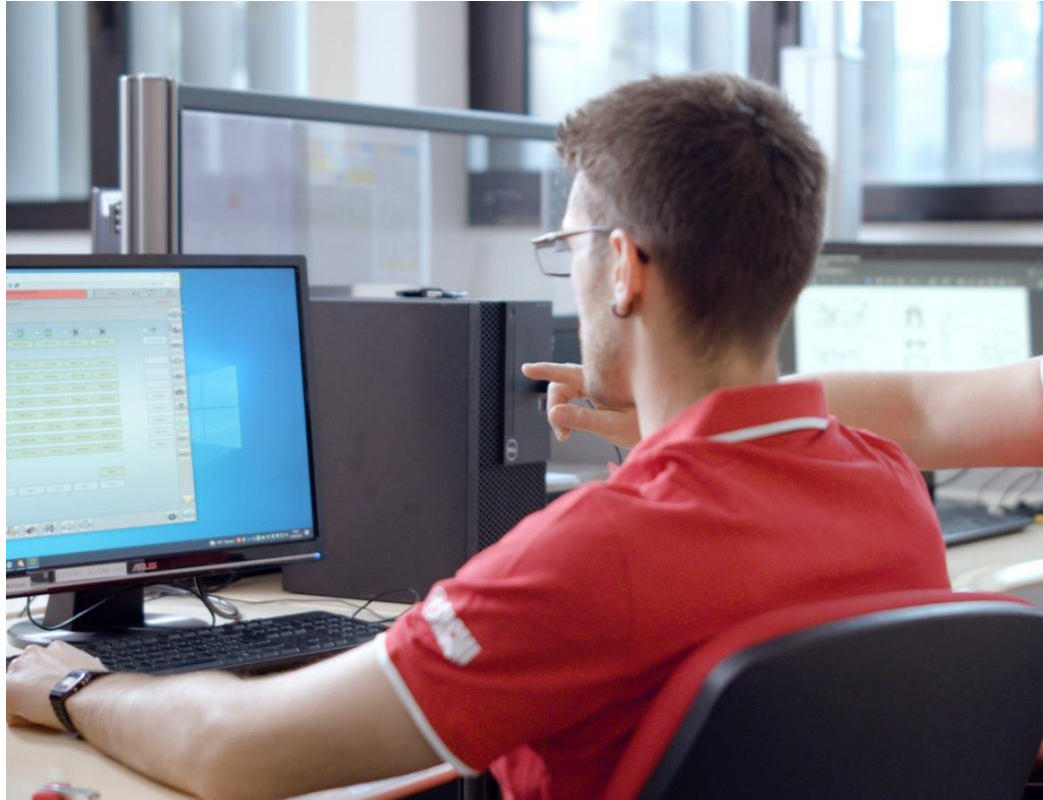

Digital E-LEARNING platform:

tutorials and videos are available 24/7 on the platform, allowing customers to learn at their own pace to match their skills requirements and production schedules



SACMI

ENDLESS INNOVATION SINCE 1919

Thank you
for your attention

